



# DREAMBUILDER

CUSTOM HOMES, LLC

12668 ARROWLEAF LANE  
JACKSONVILLE, FL 32225

P. (904) 612-6946

F. (904) 677-7867

[WWW.YOURDREAMBUILDER.COM](http://WWW.YOURDREAMBUILDER.COM)

CBC 1255550

Jon & Vivian McDonald  
4407 Seabreeze Dr  
Jacksonville, FL 32250

## Dreambuilder Thirteen: Kitchen Renovation

### Scope/Specifications

- Permits, plans and engineering
- Reconstruction of exterior wall
- Installation of new Alenco aluminum window and sliding glass door, white
- Stucco exterior with paint (will match as closely as possible)
- Demolition of interiors, including floors, pantry and existing cabinetry
- Electrical rewiring as required per plans
  - Surface mount light fixtures not included (cap off breakfast room fixture)
  - Undercabinet light fixtures included
  - Additional electrical:
    - Install two outlets on backsplash at buffet
    - Install one quad outlet in each appliance garage
    - Note: outlet for microwave needed in cabinet. Microwave is not hardwired.

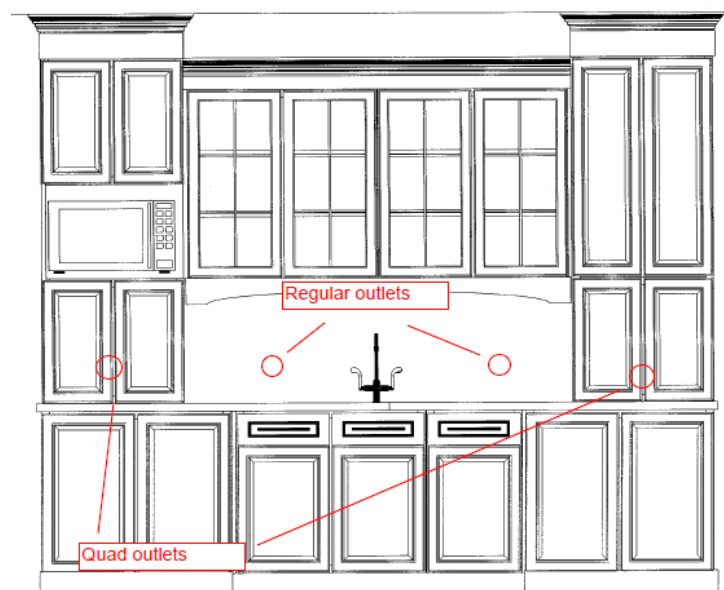

- Replumbing as required by plans
  - Plumbing fixtures
    - Main faucet: Kohler Forte single control pullout K-10433-VS, stainless steel
    - Bar sink faucet: Kohler Carafe K-18865-VS, stainless steel (connect to filtration system provided by owner)
- Exterior venting for hood
- Gas line for cooktop
- Pocket door at pantry; elimination of doorway to hall; open full doorway at arch
- Interior drywall, paint and trim: equivalent to Porter Paints 6878-2, mellow grain, eggshell
- Tile flooring:
  - Delanov, chiara cream, 20x20 on diagonal
  - grout: Mapei 15 bone with Stain Free
  - FractureGuard underlayment
  - Do not tile under cabinets
  - Install strip of 2x2 Delanov across arched doorway to family room as a border
- Interior cleaning

#### **Aristokraft cabinetry**

- Door style: Briarcliff square, cherry, cocoa glaze
  - Full overlay
  - Raised panel
  - Five-piece drawer front
- Ply Select series
  - Full plywood cabinet box
  - All wood dovetail drawers with concealed guides
- FX option
  - Full extension undermount drawer slides
  - Soft-close drawers
- Additional inclusions:
  - 42" uppers
  - Custom pocket door slab
  - Large crown molding
  - Light rail molding
  - Matching shoe molding
  - Full height double trash drawer
  - x2 E-Z access base corner cabinets with bi-fold doors (lazy Susans not included)
  - Tilt-out trays at main sink
  - Cutlery insert
  - Pots and pans drawer stack
  - Base pantry spice rack pull out
  - Oven tower with veneered side
  - False end panels on back and side of peninsula
  - Hood box to include false panels on front and valance

- Buffet hutch
  - x2 custom built upper towers, 27w x 24h x 18d appliance garages; no frame at bottom of each garage; left tower to include microwave shelf
  - x2 pairs of glass doors with mullions, standard glass; cabinet interiors to match finish; wood shelves
  - Valance over bar sink
- Hardware: JA Tuscan: drawers: 749-128 SIM (inc. trash drawer); doors: 749 SIM (inc. spice drawer)

**Granite countertops: crema bordeaux (exotic slab)**

- Stain treatment
- Upgraded ogee edge
- Cut-outs for cooktop, main sink and bar sink
- Stainless steel undermount main sink 801R
- Stainless steel undermount bar sink DXUH 1618
- 4" splash on sink wall; full granite splash on other walls
- Total 4 ½" overhang along length of edge on breakfast room side of peninsula
- Shaped end on peninsula per cabinet profiles

**Appliances**

- ZGU385LSMSS Monogram 36" cooktop, stainless, gas (propane)
- ZET2RMSS Monogram 30" double oven, stainless, convection
- ZVC36LSS Monogram 36" power pack/liner, custom hood
- ZE2160SF Monogram counter-top microwave, 2.1 CF, stainless
- JX 2127SH Monogram microwave 27" trim kit, stainless
- GFC520F ½ HP disposer

## Schedule Estimate

- Week 1: May 9
  - Day 1 Dumpster delivery
  - Day 2 Portolet delivery
  - Day 3 Cabinet demo
  - Day 4 Plumbing demo/cabinet measure
  - Day 5 Electric demo/cabinet measure
- Week 2: May 16
  - Day 1 Flooring demo
  - Day 2 Concrete/windows/interior reconfiguration
  - Day 3 Concrete/windows/interior reconfiguration
  - Day 4 Concrete/windows/interior reconfiguration
  - Day 5 Concrete/windows/interior reconfiguration
- Week 3: May 23
  - Day 1 Concrete/windows/interior reconfiguration
  - Day 2 Concrete/windows/interior reconfiguration
  - Day 3 Gas work/set hood venting
  - Day 4 Electrical/stucco
  - Day 5 Electrical
- Week 4: May 30
  - Day 1 Plumbing
  - Day 2 Drywall
  - Day 3 Drywall
  - Day 4 Install cabinets
  - Day 5 Measure for countertops
- Week 5: June 6
  - Day 1 Install flooring
  - Day 2 Trim
  - Day 3 n/a
  - Day 4 n/a
  - Day 5 n/a
- Week 6: June 13
  - Day 1 Paint (interior)
  - Day 2 Install countertops/paint (exterior)
  - Day 3 Install backsplash
  - Day 4 Install appliances/plumbing trim/electrical trim
  - Day 5 Cleaning/final inspection