

LEGEND (SJC)

EXISTING

PROPOSED

+8.01

10.00

SPOT ELEVATION

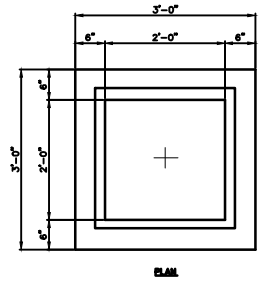

- SPECIFICATIONS:
- STEEL: GRADE 60
BASE: #3 @ 8" O.C.B.W.
WALLS: #3 @ 8" O.C.B.W.
2" CLEARANCE TO INSIDE FACE
 - 4,000 P.S.I. CONCRETE, TYPE II CEMENT
 - USF #6278 TRAFFIC GRATE

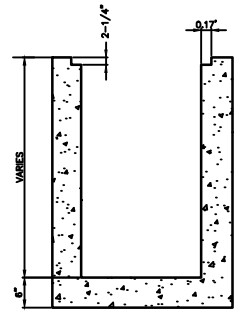

9TH AVENUE SOUTH

(DAVIS STREET PER PLAT)

(50' R/W)

BENCHMARK:
FND NAIL & DISK
BTS LB 6991
ELEV. 8.24

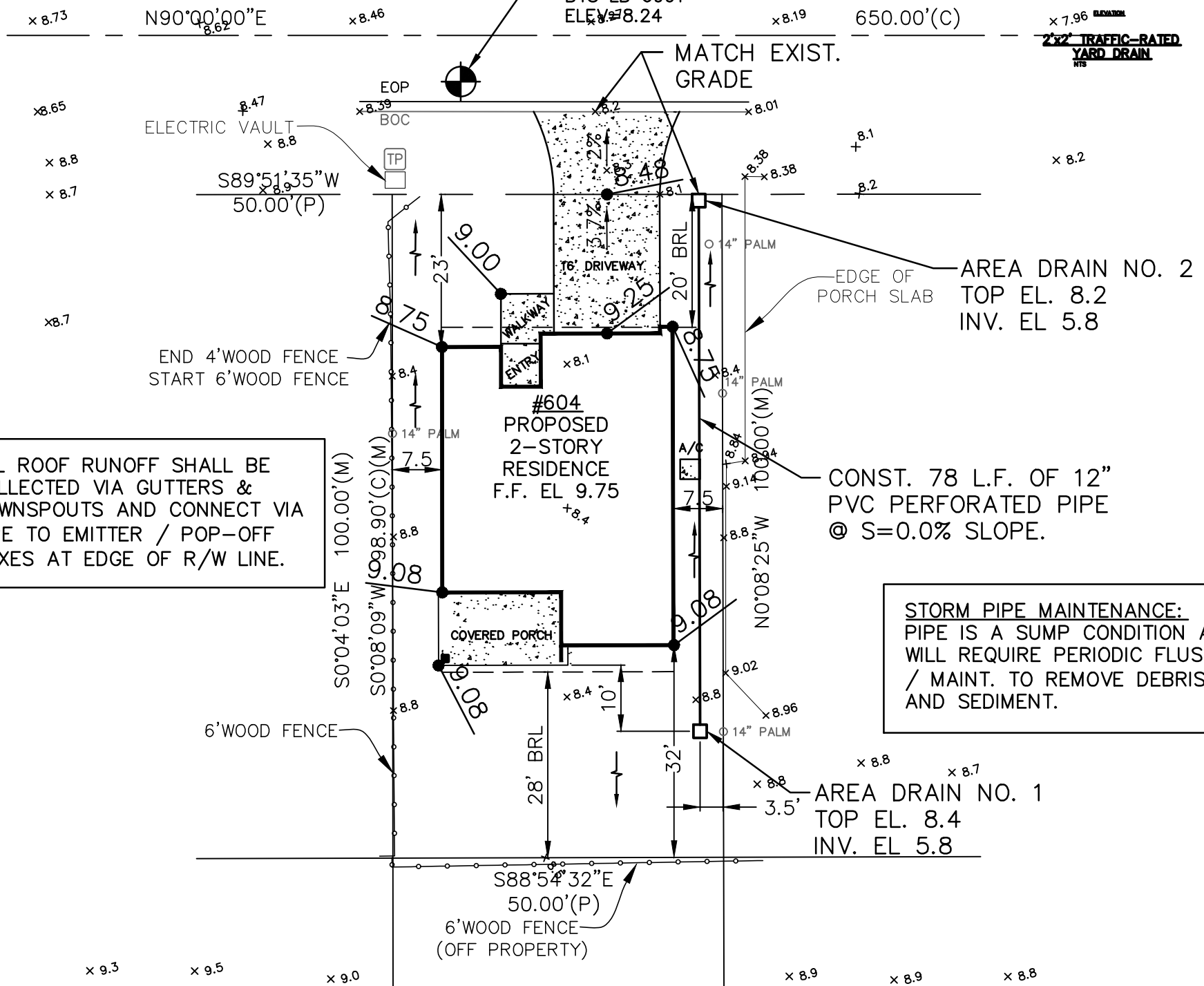

ALL ROOF RUNOFF SHALL BE COLLECTED VIA GUTTERS & DOWNSPOUTS AND CONNECT VIA PIPE TO EMITTER / POP-OFF BOXES AT EDGE OF R/W LINE.

STORM PIPE MAINTENANCE:
PIPE IS A SUMP CONDITION AND WILL REQUIRE PERIODIC FLUSHING / MAINT. TO REMOVE DEBRIS AND SEDIMENT.

- NOTES:
- COORDINATE WATER & SEWER SERVICE WITH COJB PUBLIC WORKS.
 - SURVEY BY BARTRAM TRAIL SURVEYING, INC. DATED AUG. 25, 2016 (PROJ. 1113-16-003).
 - REFER TO ARCHITECTURAL PLANS FOR HOUSE AND DRIVEWAY DIMENSIONS.
 - SEED / SOD DISTURBED AREAS IN R/W AS REQUIRED BY COJB PUBLIC WORKS.
 - 4:1 MAX. SLOPE FROM PATIO OR PORCH TO EXIST. GRADE.
 - MATCH EXIST. GUTTER GRADE W/ NEW DRIVEWAY.
 - BROKEN CURBS MUST BE REPLACED BEFORE A C/O IS ISSUED.

SITE DATA SUMMARY	
TOTAL SITE:	5,000 SF
PROPOSED IMPERVIOUS AREA:	
RESIDENCE:	1,429 SF
DRIVEWAY/CONC:	644 SF
TOTAL:	2,073 SF
PROPOSED LOT COVERAGE:	
2,073 SF / 5,000 SF = 41.5%	
(MAX. 43% ALLOWED PER VARIANCE)	

SJC
S. JOHNSON CONSULTANTS, INC.
8515 BAYMEADOWS WAY, STE 401 JAX., FL. 32256
(904) 721-1888, 721-8464 FAX EB-0007681
SCOTT JOHNSON, PE - FL LIC. NO. 37534

LOT GRADING PLAN
604 9th AVENUE SOUTH, JAX BEACH
FOR
STARR CUSTOM HOMES, LLC
JACKSONVILLE FLORIDA
PROJECT NO. 16-014 DECEMBER 7, 2016