

BM1 LP-LSL 1.55E 1.750" X 20.000" 2-Ply - PASSED

Level: Level

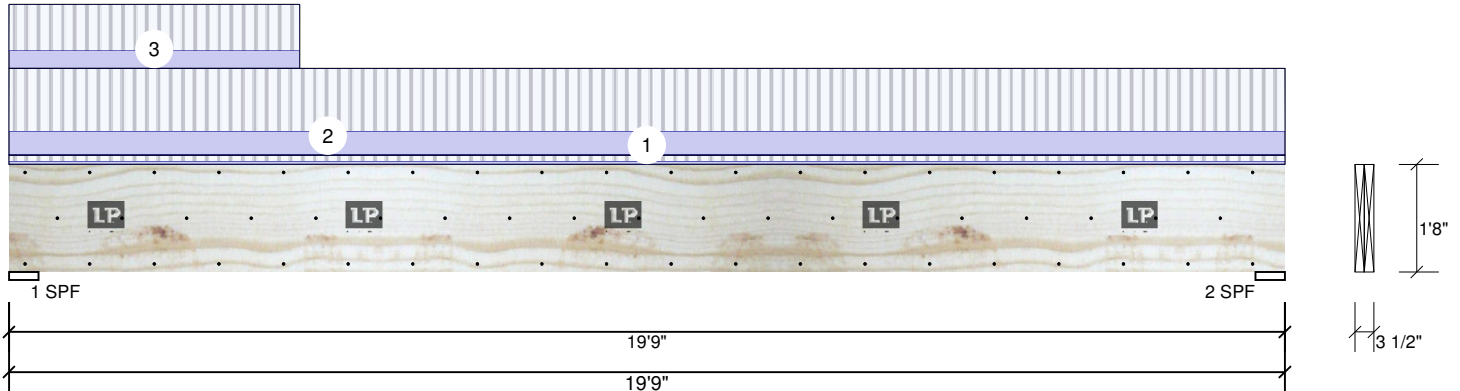

Member Information

Type:	Girder
Plies:	2
Moisture Condition:	Dry
Deflection LL:	480
Deflection TL:	240
Importance:	Normal
Temperature:	Temp <= 100°F

Application:	Floor
Design Method:	ASD
Building Code:	IBC 2012
Load Sharing:	No
Deck:	Not Checked

Reactions lb (Uplift)

Brg	Live	Dead	Snow	Wind	Const
1	5142	2145	0	0	0
2	4160	1777	0	0	0

Bearings

Bearing	Length	Cap. React	D/L lb	Total	Ld. Case	Ld. Comb.
1 - SPF	5.500"	89%	2145 / 5142	7287	L	D+L
2 - SPF	5.500"	73%	1777 / 4160	5937	L	D+L

Analysis Results

Analysis	Actual	Location	Allowed	Capacity	Comb.	Case
Moment	27918 ft-lb	9'7 1/16"	43159 ft-lb	0.647 (65%)	D+L	L
Shear	6207 lb	17'8 3/8"	19133 lb	0.324 (32%)	D+L	L
LL Defl inch	0.396 (L/576)	9'9 5/16"	0.474 (L/480)	0.830 (83%)	L	L
TL Defl inch	0.564 (L/404)	9'9 5/16"	0.949 (L/240)	0.590 (59%)	D+L	L

Design Notes

- 1 Provide restraint at supports to ensure lateral stability.
- 2 Dead Load Deflection: Instant = 0.168", Long Term = 0.252"
- 3 Fasten all plies using 3 rows of 10d Box nails (.128x3") at 12" o.c. sMaximum end distance not to exceed 6".
- 4 Refer to last page of calculations for fasteners required for specified loads.
- 5 Girders are designed to be supported on the bottom edge only.
- 6 Top loads must be supported equally by all plies.
- 7 Top must be laterally braced at a maximum of 3'8 1/4" o.c.
- 8 Bottom braced at bearings.
- 9 Lateral slenderness ratio based on single ply width.

ID	Load Type	Location	Trib Width	Side	Dead 0.9	Live 1	Snow 1.15	Wind 1.6	Const. 1.25	Comments
1	Uniform		1-0-0	Top	15 PSF	40 PSF	0 PSF	0 PSF	0 PSF	
2	Part. Uniform	0-0-0 to 19-9-0		Near Face	138 PLF	369 PLF	0 PLF	0 PLF	0 PLF	F02
3	Part. Uniform	0-0-0 to 4-6-0		Far Face	102 PLF	272 PLF	0 PLF	0 PLF	0 PLF	F04
	Self Weight				22 PLF					

Notes

This component analysis is based on the loads, geometry and other conditions as entered by the user and listed in this report. The user is responsible to ensure the accuracy of the input and the applicability to the actual conditions of the structure for which this component is intended. This analysis is valid only for the product listed.
Copyright 2016 All rights reserved by Louisiana Pacific Corp. 414 Union St Suite 2000, Nashville, TN 37219

Manufacturer Info

Louisiana-Pacific Corp
414 Union Street, Suite 2000
Nashville, TN 37219
(888) 820-0325
www.lpcorp.com
APA: PR-L280, ICC-ES: ESR-2403,
LADBS: RR-25783, Florida: FL15228

This design is valid until
6/30/2018

BM1 LP-LSL 1.55E 1.750" X 20.000" 2-Ply - PASSED

Level: Level

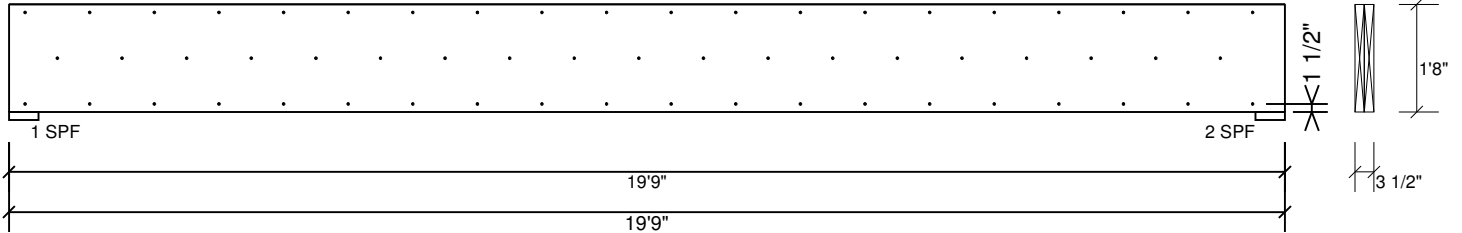

Multi-Ply Analysis

Fasten all plies using 3 rows of 10d Box nails (.128x3") at 12" o.c.. Maximum end distance not to exceed 6"

Capacity	85.4 %
Load	253.5 PLF
Yield Limit per Foot	296.8 PLF
Yield Limit per Fastener	98.9 lb.
Yield Mode	IV
Edge Distance	1 1/2"
Min. End Distance	3"
Load Combination	D+L
Duration Factor	1.00

Notes

This component analysis is based on the loads, geometry and other conditions as entered by the user and listed in this report. The user is responsible to ensure the accuracy of the input and the applicability to the actual conditions of the structure for which this component is intended. This analysis is valid only for the product listed.

Copyright 2016 All rights reserved by Louisiana Pacific Corp. 414 Union St Suite 2000, Nashville, TN 37219

Manufacturer Info

Louisiana-Pacific Corp
 414 Union Street, Suite 2000
 Nashville, TN 37219
 (888) 820-0325
 www.lpcorp.com
 APA: PR-L280, ICC-ES: ESR-2403,
 LADBS: RR-25783, Florida: FL15228

This design is valid until
 6/30/2018